

Product Information

ON-008..015GM

**Flow Indicator
ON-...GM**



- No moving parts internally
- For heavily soiled or coloured fluids
- Natural glass

Characteristics

Devices made from solid brass, where the medium enters from above, and so can be visually examined through the sight glass (colour, bubbles, amount...). The device has a drip nozzle for the inspection of small flow rates.

Technical data

Nominal width	DN 8..15
Process connection	female thread G 1/4..G 1/2
Q_{max.}	G 1/4 - 15 l/min G 3/8 - 20 l/min G 1/2 - 40 l/min
Pressure resistance	PN 6 bar
Medium temperature	-20..+70 °C
Ambient temperature	-20..+70 °C
Materials medium-contact	CW614N pickled, natural glass
Medium	water, oils
Weight	see table "Dimensions and weights"
Installation location	vertical inwards flow from above; other installation arrangements without drip nozzle function.

Dimensions and weights

G	Types	D	SW	X	Weight kg
G 1/4	ON-008GM	5	19	12	0.08
G 3/8	ON-010GM	8	27	11	0.16
G 1/2	ON-015GM	12	32	10	0.20

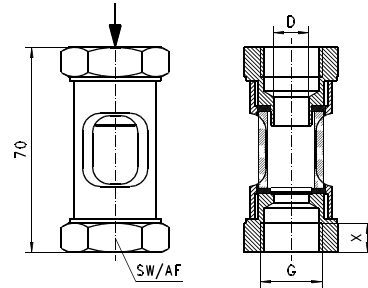

Ordering code

ON - 1. 2. 3.
 G M

1. Nominal width		
008	DN 8 - G 1/4	
010	DN 10 - G 3/8	
015	DN 15 - G 1/2	
2. Process connection		
G	female thread	
3. Connection material		
M	brass	